

MINI-F^{FIX} LED

24V-AC/DC
100÷240V-AC

3W
6.000°K 40.000 hours

RoHS RAEE CONFORMITY



IP65



EUROPEAN INDUSTRIAL COMPONENTS

miniF-001



MN03 L40-F500-24ACDC
MN03 L40-F500-100240AC

MN03 L40-F700-24ACDC
MN03 L40-F700-100240AC

HIGH PERFORMANCES

- ❑ Up to 85% energy saving
- ❑ Low performing heat
- ❑ Zero maintenance
- ❑ Aluminium adjustable head with high resistance glass
- ❑ Easily adjustable and vibration-resistant flexible arms
- ❑ Resistant to coolants and lubricants
- ❑ Complies with Directives 2006/95/EC, 2004/108/EC and 2006/42/EC as required by Normative EN 1387

MINI-F LED IP65

24V-AC/DC
100-240V-AC

3W
6.000°K 40.000 hours

RoHS RAEE CONFORMITY



2 voltage options:
 -24V-AC/DC with LED driver built-in the base and 2-pole cable
 -100-240V-AC with LED driver built-in the base and cable with 10A Euro plug
Optional accessories:
 mounting clamp, angle plate and magnetic base

MINI-F LED 24V-AC/DC, 3W

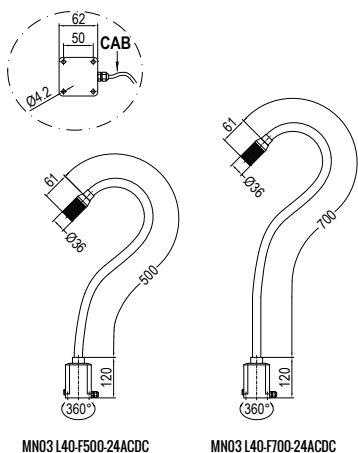

MN03 L40-F500-24ACDC

MN03 L40-F700-24ACDC

MINI-F LED 100-240V-AC, 3W

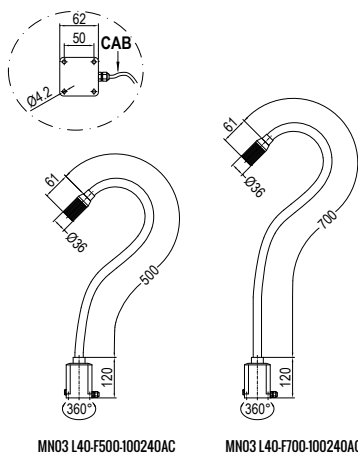

MN03 L40-F500-100240AC

MN03 L40-F700-100240AC

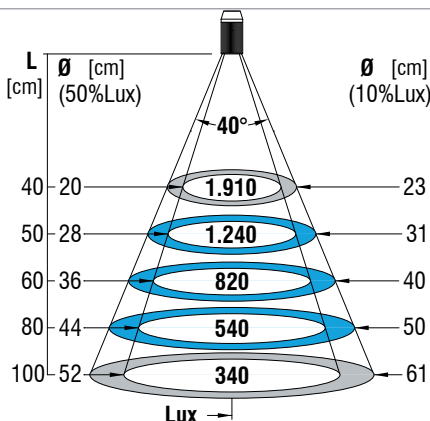

MINI-F LED 24V-AC/DC

STANDARD

CODE	Vin	WxLed	CAB. mt	Kg
MN03 L40-F500-24ACDC	24V	3Wx1	CV 02	0.75
MN03 L40-F700-24ACDC	AC/DC		1.80	1.00

MINI-F LED 100-240V-AC

STANDARD

CODE	Vin	WxLed	CAB. mt	Kg
MN03 L40-F500-100240AC	100-240V	3Wx1	SP 04	0.75
MN03 L40-F700-100240AC	AC		1.80	1.00

OPTIONS

