

CLIK LED

24V-AC/DC
100÷240V-AC

12W
6.000°K 40.000 hours

RoHS RAE CONFORMITY



IP65



EUROPEAN INDUSTRIAL COMPONENTS

clik-001



Joints equipped with wing nut
for comfort clamping



Ergonomic on/off switch

HIGH PERFORMANCES

- Up to 85% energy saving
- Low performing heat
- Zero maintenance
- Adjustable extruded aluminium head with high resistance glass
- Easily adjustable arms
- Resistant to coolants and lubricants
- Complies with Directives 2006/95/EC, 2004/108/EC and 2006/42/EC as required by Normative EN 1387

CLIK LED IP65

24V-AC/DC
100÷240V-AC

12W
6.000°K 40.000 hours

RoHS RAEE CONFORMITY



2 voltage options:

•24V-AC/DC with LED driver built-in the head and 2-pole cable

•100÷240V-AC with LED driver built-in the base and cable with Schuko plug

Standard:

60° LED Module (25° in option)

Optional accessories:

coloured glasses, mounting clamps and angle plate

CLIK LED 24V-AC/DC, 12W

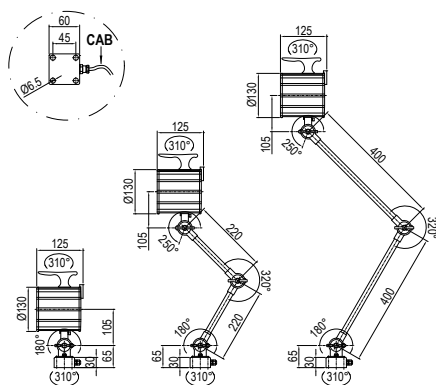

CN12 L60-S-24ACDC
CN12 L25-S-24ACDC

CN12 L60-M/2-24ACDC
CN12 L25-M/2-24ACDC

CN12 L60-L /2-24ACDC
CN12 L25-L /2-24ACDC

CLIK LED 100÷240V-AC, 12W

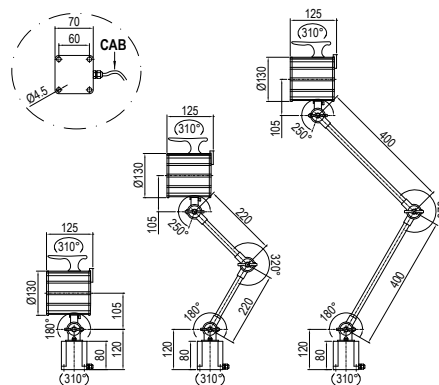

CN12 L60-S-100240AC
CN12 L25-S-100240AC

CN12 L60-M/2-100240AC
CN12 L25-M/2-100240AC

CN12 L60-L /2-100240AC
CN12 L25-L /2-100240AC

CN12 L60...

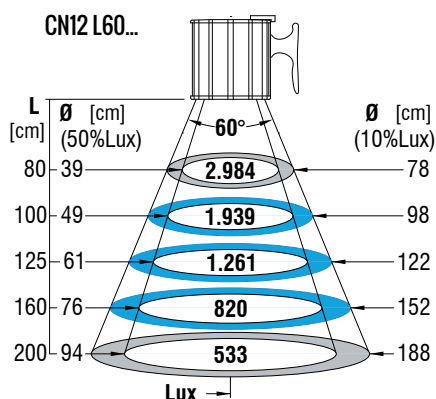

CN12 L25...

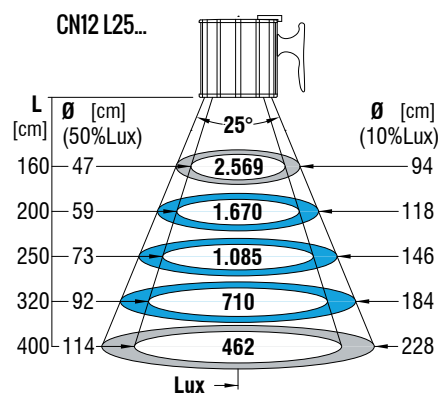

CLIK LED 24V-AC/DC

	CODE	Vin	WxLed	CAB. mt	Kg
STANDARD: 60° LED Module	CN12 L60-S-24ACDC	24V AC/DC	2Wx6	CV 02 1.80	1.80
	CN12 L60-M/2-24ACDC				2.00
	CN12 L60-L /2-24ACDC				2.40
OPTION: 25° LED Module	CN12 L25-S-24ACDC	24V AC/DC	2Wx6	CV 02 1.80	1.80
	CN12 L25-M/2-24ACDC				2.00
	CN12 L25-L /2-24ACDC				2.40

CLIK LED 100÷240V-AC

	CODE	Vin	WxLed	CAB. mt	Kg
STANDARD: 60° LED Module	CN12 L60-S-100240AC	100÷240V AC	2Wx6	SP 02 1.80	2.00
	CN12 L60-M/2-100240AC				2.20
	CN12 L60-L /2-100240AC				2.60
OPTION: 25° LED Module	CN12 L25-S-100240AC	100÷240V AC	2Wx6	SP 02 1.80	2.00
	CN12 L25-M/2-100240AC				2.20
	CN12 L25-L /2-100240AC				2.60

OPTIONS AND SPARE PARTS

	NEUTRAL GLASS	BLUE GLASS	YELLOW GLASS	CLAMP CLIK 24V-AC/DC	CLAMP CLIK 100÷240V-AC	ANGLE PLATE CLIK UNIVERSAL
CODE	FIL 109N	FIL 109A	FIL 109G	J C01	J C02	J L01/02